

**RATINGS OF MANGANESE DIOXIDE LITHIUM BATTERY**

(TYPE: CR1632)

CLASSIFICATION		MANGANESE DIOXIDE LITHIUM PRIMARY BATTERY
BATTERY SYSTEM		COIN TYPE MANGANESE DIOXIDE LITHIUM BATTERY
BATTERY TYPE		CR1632
NOMINAL VOLTAGE		3.0V
NOMINAL CAPACITY		120mAh (ON CONTINUOUS DISCHARGE UNDER 15K $\Omega$ load to 2.0V end-point)
STANDARD DISCHARGE CURRENT		0.1mA
MASS		APPROX. 2.0g
TERMINALS	CAP TERMINAL CASE TERMINAL	SUS430+Ni-paltd SUS430+Ni-paltd
OUTER DIMENSIONS	DIAMETER OVERALL HEIGHT	$\phi 16.0(+0/-0.3)$ mm 3.2(+0/-0.3)mm
USABLE TEMPERATURE RANGE		-20 $^{\circ}$ C ~ +70 $^{\circ}$ C
STORAGE TEMPERATURE RANGE		0 $^{\circ}$ C ~ 30 $^{\circ}$ C
STORAGE HUMIDITY RANGE		40% ~ 75%

The Appearance Of CR1632

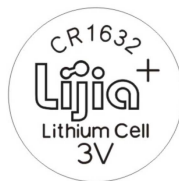

The Dimensions Of CR1632

Fig.1

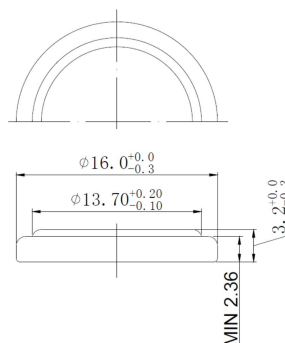

## Specifications

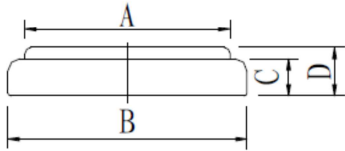
Nominal Voltage	3V	<p style="text-align: center;">Dimensions (mm)</p> 	A	$\phi 13.7$
Nominal Capacity	120 (mAh)		B	$\phi 16.0^{+0.0}_{-0.3}$
Continuous standard load	15 (K $\Omega$ )		C	2.36 (Ref.)
Operating temperature	-20 ~ 70°C		D	$3.2^{+0.0}_{-0.3}$
Weight	2.0 (g)			

### Discharge characteristics

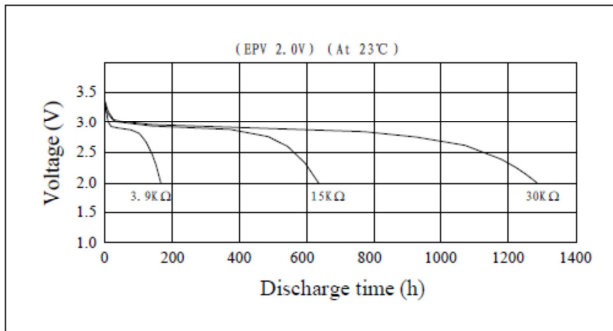

### Temperature characteristics

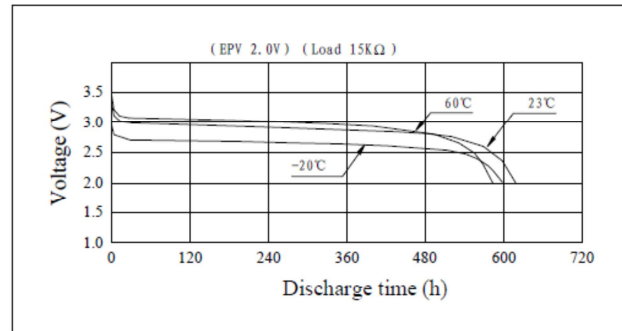

### Load vs. Operating voltage

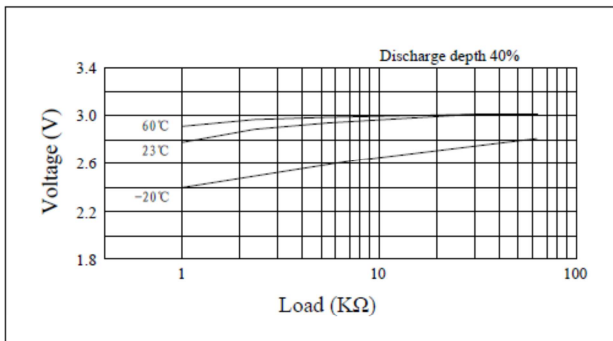

### Load vs. Capacity

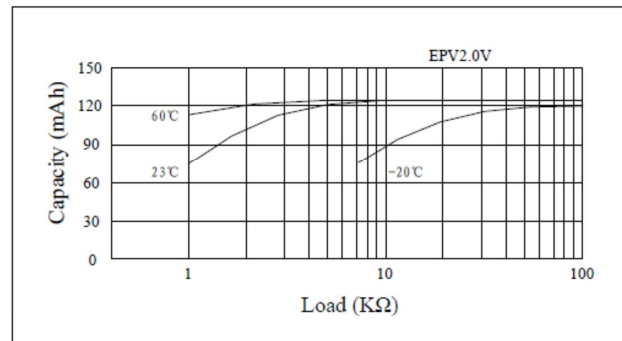

### Pulse discharge characteristics

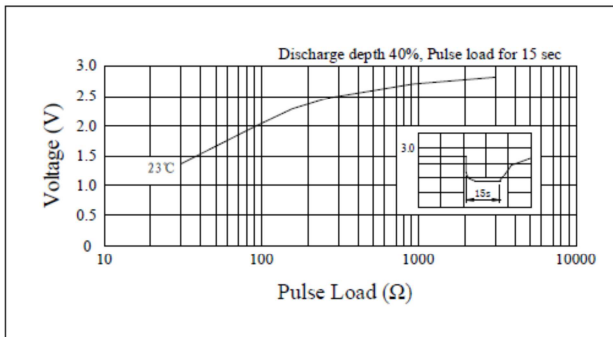

### Storage characteristics

