



HW-40152S 17Ah

Technical Specification

Lithium iron phosphate battery

Specification

Nominal Voltage	3.2V
Nominal Capacity(0.5C,25°C)	17Ah
Weight(Approximate)	480±5g

Standard Discharge

Recommended Discharge Current	17A
Max. Continuous Current	34A
Max. 3 sec. Pulse	170A
Cut-off Voltage	2.0V

Standard Charge

Charge Voltage	3.65V
Recommended Charge Current	8.5A
Max. Charge current	17A

Others

Internal Resistance	≤4mOhm
Self-discharge rate	≤2% per month
0.5C/1C cycle life	≥2000 Times

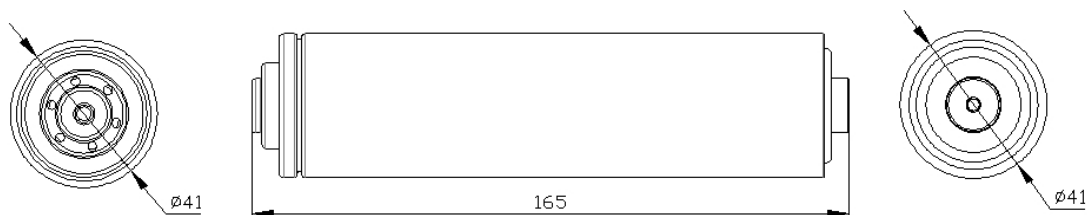
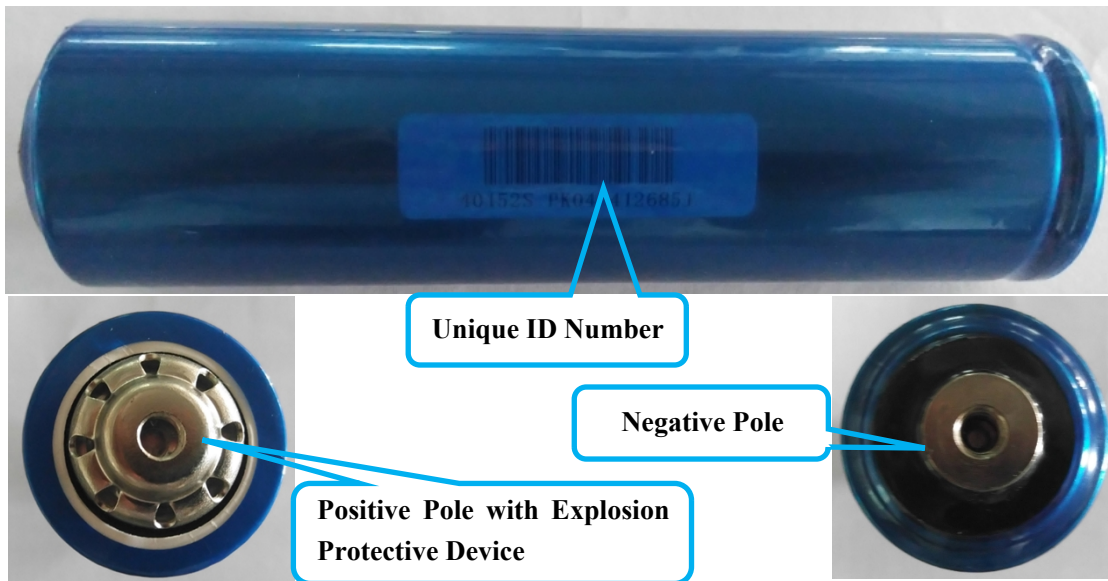

Check with the real products, the specifications are for reference only. It can be designed according to customer's requirements if necessary.