

- **TOP PERFORMANCE** • **TOP QUALITY** • **TRIED AND TRUSTED IN THE FIELD** •

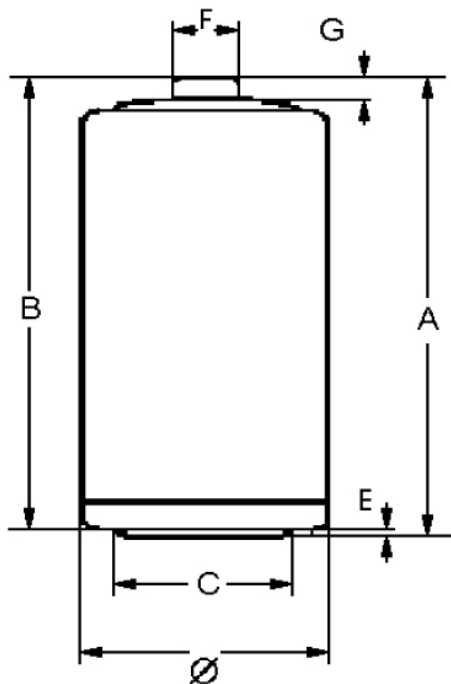

<b>Type Designation</b>	4020
<b>Designation IEC</b>	LR20
<b>System</b>	Zn-MnO <sub>2</sub> (Alkaline)
<b>Shelf Life (Coding)*</b>	5 years
<b>Nominal Voltage [V]</b>	1.5
<b>Typical Capacity C [mAh]</b>	17000 (discharge with high-resistance)
<b>Permissible Temperature Range</b>	- 20 °C ... 50 °C
<b>Weight, approx. [g]</b>	138
<b>Volume [ccm]</b>	51.3
<b>Dimensions [mm]</b>	
	<b>min:      max:</b>
Ø	32.3    34.2
A	-        61.5
B	59.5    -
C	18.0    -
E	-        1.0
F	-        9.5
G	1.5     -

**Typical Capacities (at 20°C)**

Discharge Type	Load	End Voltage[V]	0.9
4M/15M, 8H/D, 7D/W Portable lighting (2)	1.5 Ω	Time [h]	14,9
		Capacity [Ah]	11,2
		Energy [Wh]	12,6
4M/H, 8H/D, 7D/W Portable lighting (1)	2.2 Ω	Time [h]	25,9
		Capacity [Ah]	13,4
		Energy [Wh]	15,3
1H/D, 7D/W Toy	2.2 mA	Time [h]	29,4
		Capacity [Ah]	14,3
		Energy [Wh]	15,8
2H/D, 7D/W Portable Stereo	600 mA	Time [h]	16,4
		Capacity [Ah]	10,1
		Energy [Wh]	11,2
4H/D, 7D/W Radio	10 Ω	Time [h]	134,4
		Capacity [Ah]	16,2
		Energy [Wh]	19,1

\* In consideration of typical loss of capacity at storage and application.